

The information contained in this drawing is the sole property of CWS Coil Winding Specialist. Any reproduction in part or whole without written permission of CWS Coil Winding Specialist is prohibited.

REVISION HISTORY			
REV	ECN	DESCRIPTION	SBN & DATE
A		PRODUCTION RELEASE	TRK 7/22/04
			DATE
		TRK	7/22/04

- 6 USING PERMANENT MARKING METHODS
- IF REQUIRED, MARK CWS PART NUMBER

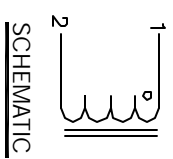

- 5 LEADS MUST BE CO-PLANAR WITH FLAT SURFACE
- REMOVE INSULATION, TIN LEADS SECTION THAT WRAP AROUND BOBBIN

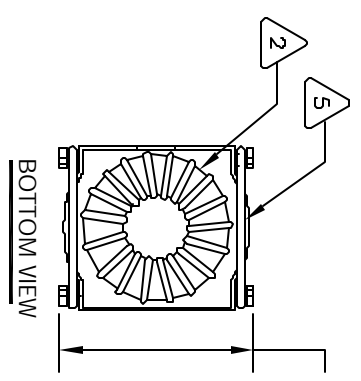
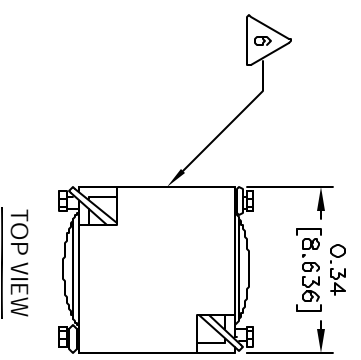

- 4 WIND COILS EVENLY SPACED
- CONSTRUCTION:

HI-POT TEST FOR WINDING TO CORE ISOLATION = 500 VDC MIN  
 SRF = 35.0 MHZ MIN.  
 CURRENT RATING = 1.6 AMPS, 40 °C TEMP. RISE, NO AIR FLOW  
 DCR = 100.0 MILLI-OHMS

- 3 DC BIAS OF 1.4 AMPS, INDUCTANCE = 8.0 UH
- L = 10 UH ± 10 % @ LOW DC BIAS, 1 KHZ; 250 mV
- SPECIFICATIONS:

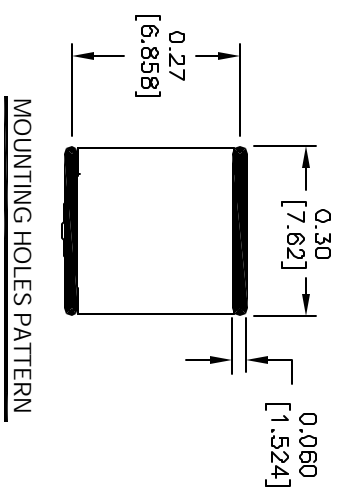
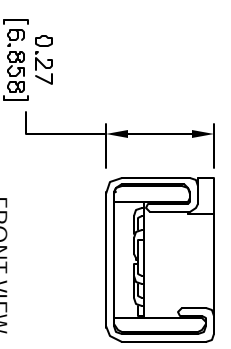

- 2 WIRE: UL RECOGNIZED 155°C RATED MAGNET WIRE
- CWS BYTEMARK OR OTHER APPROVED PART
- CORE: COATED HIGH FLUX TOROID

- 1. RATING CLASS B (130°C MIN.) REQUIRED
  - MATERIAL: UL RECOGNIZED 94V-0 FLAMMABILITY
- NOTES: SURFACE MOUNT INDUCTOR

CODE	IDENT	MFG. P/N	DESCRIPTION	ITEM NO.
AUTOCAD		X		
SOLIDWORKS				
SKIN	DATE			
DRAWN	RFR	7/22/04		
CHECKED	TDK	7/22/04		
ENGR	JLAV	7/22/04		
APPR	JLAV	7/22/04		
TITLE:		Surface Mount Power Chokes		
SIZE		B		
SCALE		1=1		