

The information contained in this drawing is the sole property of Coil Winding Specialist. Any reproduction in part or whole without written permission of Coil Winding Specialist is prohibited.

DIMENSIONAL TOLERANCE INCHES [MM]					
A(OD) MAX	B (WIDTH) MAX	C(LEAD) MIN	D(LEAD DIA) MIN	P1 REF	P2 REF
1.32" [33.50]	0.75" [19.0]	0.50" [12.70]	0.04" [1.02]	0.25" [6.35]	1.10" [27.94]

REVISION HISTORY			SIGN & DATE			
REV	ECN	DESCRIPTION	BY	DATE	CHEK	DATE
B	N/A	ELEC. AND MECH. UPDATED	AK	3/16/11	JLU	3/16/11
C	N/A	ELEC. AND MECH. UPDATED	AK	11/08/12	JLU	11/08/12
D	160208	REVISE ELECTRICAL AND DIMENSIONS	AK	02/15/16	JM	02/15/16
D1	160208	REVISE DESCRIPTION	AK	07/07/17	JLU	07/07/17

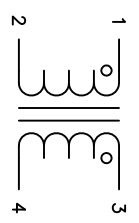

**SCHEMATIC**

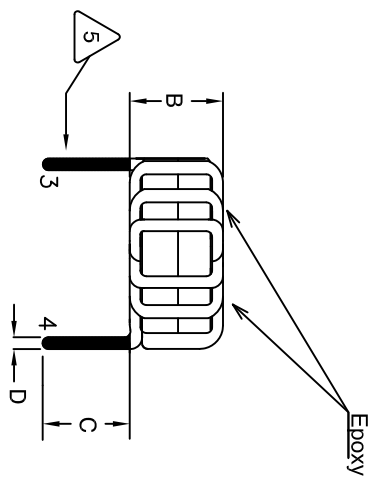

**FRONT VIEW**

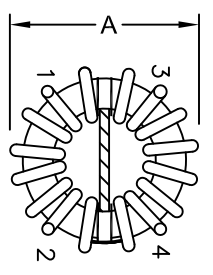

**BOTTOM VIEW**

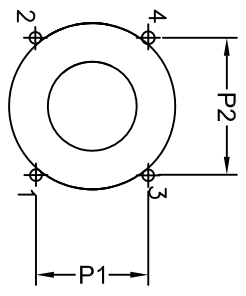

**FOOTPRINT**

- 7 BUILT TO ROHS COMPLIANCE
- 6 MARK PART NUMBER AND REVISION IF APPLICABLE.
- WITH COIL EDGE.  
TRIM LEADS APPROX. 0.5 INCH AND FLUSH APPLY EPOXY TO SPACER WHERE SHOWN.  
REMOVE WIRE INSULATION AND TIN.
- 5 WIND COILS EVENLY SPACED  
CONSTRUCTION:

- 4 WEIGHT = 32 GRAMS  
MAX TEMP RISE = 40°C  
OPERATING RANGE : -25° TO 120°C  
INTER WINDING ISOLATION = 2000 VOLTS RMS, 3mA, 2 sec.  
INTERWINDING CAPACITANCE = 14.60 pF TYP @ SRF  
IMPEDANCE = 16.0 KΩ TYP @ SRF  
SRF = 304.0 KHZ TYPICAL  
LEAKAGE INDUCTANCE = 25.0 uH TYP @ 10KHZ, 1Vrms  
INDUCTANCE = 48.0 mH MIN @ 1 KHz, 1 Vrms, 0 Amps  
DCR ON EACH WINDING = 25.0 mΩ MAX  
MAX VOLTAGE ACROSS TERMINALS 1-2 OR 3-4 = 250 VAC OR VDC  
RATED CURRENT = 7.0 AMPS  
INSULATION RESISTANCE = 100 MEGA-OHMS MIN @ 500 VDC  
SPECIFICATIONS @ 25°C
- 3 WIRE: UL CLASS 200°C WIRE  
CWS BYTEMARK OR OTHER APPROVED PART  
CORE: NANO CRYSTALLINE OR AMORPHOUS CORE
- 2 CASE = UL CLASS B (130°) RATING  
MATERIAL: UL RECOGNIZED
- 1

NOTES: UNLESS OTHERWISE SPECIFIED, READ FROM BOTTOM UP.

PARTS LIST	
AUTOCAD SIGN	X
SOLIDWORKS SIGN	

FORM	DATE	TITLE	SIZE	SCALE	SHEET	OF	REV
RAW	12/16/10	Nanocrystalline Inductor	3.50"	N/A	1	1	D1
DRGD	12/16/10	Common Mode Choke	3.50"	N/A			
ENGR	12/16/10	Horizontal Mount CAGE# 5DME2	3.50"	N/A			
APPR	03/16/11		3.50"	N/A			

UNLESS OTHERWISE SPECIFIED	
DIMENSIONING AND TOLERANCE PER ANSI Y14.5M	
ALL DIMENSIONS ARE IN INCHES AND [DIMENSIONS]	
TOLERANCE INCHES:	±0.030"
20X±0.008	±0.030"
10X±0.015	±0.030"
3X±0.030	±0.030"
ANGLE PROJECTION	1st Angle
DO NOT SCALE DRAWING	

UNLESS OTHERWISE SPECIFIED	
DIMENSIONING AND TOLERANCE PER ANSI Y14.5M	
ALL DIMENSIONS ARE IN INCHES AND [DIMENSIONS]	
TOLERANCE INCHES:	±0.030"
20X±0.008	±0.030"
10X±0.015	±0.030"
3X±0.030	±0.030"
ANGLE PROJECTION	1st Angle
DO NOT SCALE DRAWING	

UNLESS OTHERWISE SPECIFIED	
DIMENSIONING AND TOLERANCE PER ANSI Y14.5M	
ALL DIMENSIONS ARE IN INCHES AND [DIMENSIONS]	
TOLERANCE INCHES:	±0.030"
20X±0.008	±0.030"
10X±0.015	±0.030"
3X±0.030	±0.030"
ANGLE PROJECTION	1st Angle
DO NOT SCALE DRAWING	