

The information contained in this drawing is the sole property of CWS Coil Winding Specialist. Any reproduction in part or whole without written permission of CWS Coil Winding Specialist is prohibited.

DIMENSIONAL TOLERANCE							
A	B	C (HGT)	D (LEAD)	E (Ø DIM)		X	Y
MAX	MAX	MAX	TYP	TYP		REF	REF
1.28" [32.5]	1.28" [32.5]	0.65" [16.5]	.50" [12.7]	.029" [0.73]		1.17" [29.7]	NA

REVISION HISTORY						
REV	ECN	DESCRIPTION	SIGN & DATE			
			BY	DATE	CHK	DATE
A		INITIAL RELEASE	KLC	11/1/11	AK	11/1/11

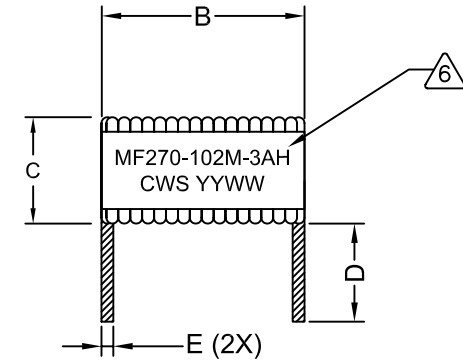
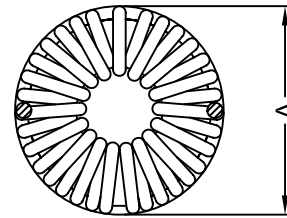
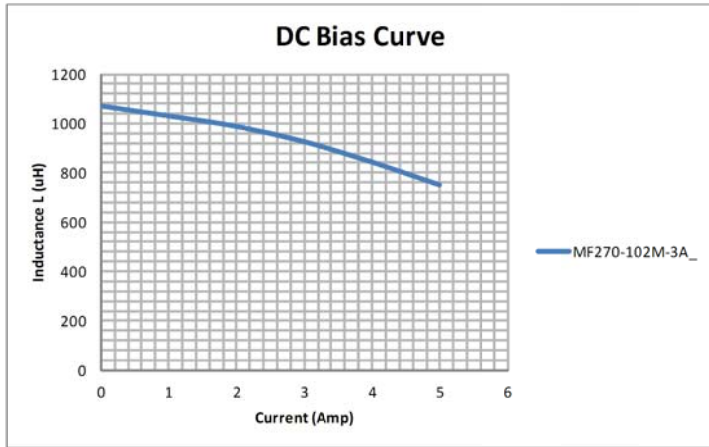

BOTTOM VIEW

SIDE VIEW

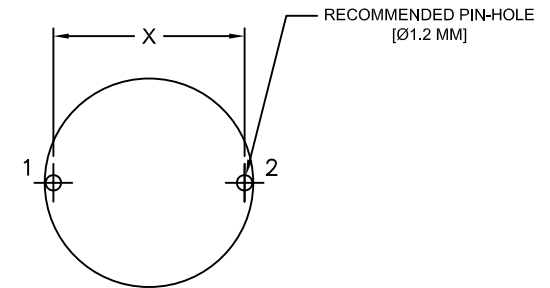
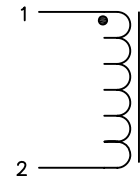

SCHEMATIC

MOUNTING HOLE PATTERN (TOP VIEW)

7 BUILT TO RoHS COMPLIANCE AND LEAD FREE.

6 IF APPLICABLE, MARK PART NUMER AND REVISION

POSITION LEADS AS REQUIRED
REMOVE WIRE INSULATION AND TIN
WIND COILS EVENLY SPACED
CONSTRUCTION:

5

4 WEIGHT: ~50 GRAMS

HI-POT WINDING-TO-CORE 1250 V AC, 10 SEC
INTERWINDING CAPACITANCE 70 pF TYPICAL @ 10 kHz
DCR= 250 mΩ MAX
SRF ~ 600 kHz TYPICAL
MAX TEMP. RISE @ IDC 3 AMP, LESS THAN 40°C WITH NO AIRFLOW
INDUCTANCE @ 0 AMP = 1000 uH±15% (LESS THAN 10% RIPPLE)
TEST FREQUENCY: 1.0 kHz ; TEST VOLTAGE: 250 mV
RATED MAX. CURRENT= 3.0 AMPS RMS ; FREQUENCY: 1kHz
OPERATING TEMPERATURE RANGE : -40° TO 180°C
SPECIFICATIONS @ 25°C

3

WIRE: UL RATED CLASS 200°C
CORE: HIGH TEMP POWDERED CORE

2

RATING UL-CLASS H (180°) REQUIRED
MATERIAL: UL RECOGNIZED 94V-0 FLAMMABILITY

1

NOTES: UNLESS OTHERWISE SPECIFIED. READ FROM BOTTOM UP.

CUSTOMER: _____

CUST REF PN: _____

APPROVED BY: _____

CODE IDENT	MFG. P/N	DESCRIPTION	ITEM NO.
PARTS LIST			
AUTOCAD SOLIDWORKS	X	WWW.COILWS.COM, INC sales@coilws.com	CWS Coil Winding Specialist. 353 W Grove Ave Orange, CA 92865 (CAGE 5DM22)
SIGN	DATE	TITLE: POWER INDUCTOR, HIGH TEMP 1000 uH, 3 Amp	
DRAWN KLC	11/1/11	SIZE B DWG. NO. MF270-102M-3AH REV A	
CHECKD AK	11/1/11		
ENGR. KLC	11/1/11		
APPR. KLC	11/1/11	SCALE 2=1	SHEET 1 OF 1

UNLESS OTHERWISE SPECIFIED
DIMENSIONING AND TOLERANCE PER ANSI Y14.5M
ALL DIMENSIONS ARE IN INCHES AND [MILLIMETERS].
TOLERANCE INCHES: .XXX±.005 .XX±.015 $\angle=40^{\circ}30'$.XX±.127 .X±.238 $\angle=40^{\circ}30'$
ANGLE PROJECTION
DO NOT SCALE DRAWING