

The information contained in this drawing is the sole property of CWS Coil Winding Specialist. Any reproduction in part or whole without written permission of CWS Coil Winding Specialist is prohibited.

DIMENSIONAL TOLERANCE										
A (OD) MAX	B (HGT) MAX	C (LEAD) MIN	D (LEAD OD) TYP	E MIN/MAX	P1 REF	P2 REF				
1.350 [34.29]	.700 [17.78]	.500 [12.70]	.051" [1.30]	.040-.080 [1.00-1.90]	.800" [20.32]	1.200" [30.48]				

REVISION HISTORY				SIGN & DATE		
REV	ECN	DESCRIPTION	BR	DATE	CHK	DATE
A		INITIAL RELEASE	KLC	10/1/10	AK	10/1/10

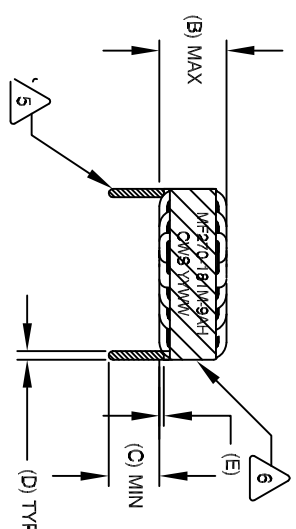

FRONT VIEW

HORIZONTAL

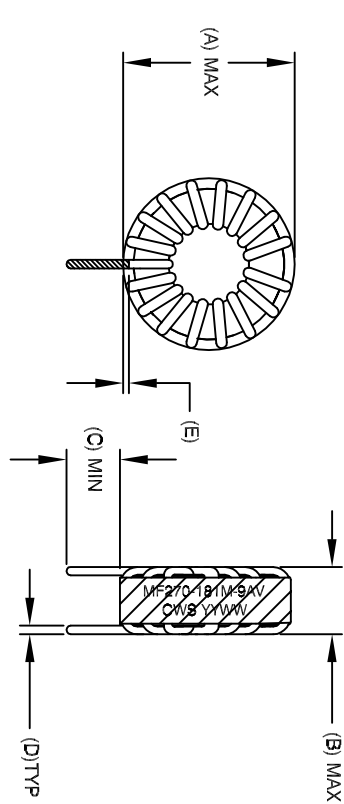

FRONT VIEW

SIDE VIEW

VERTICAL

- 6 TO THE CORE MUST REST FLAT ON PCB; LEADS MUST BE TANGENT FLUSH WITH THE COIL EDGE, AS SHOWN (I.E. COIL REMOVE INSULATION AND TIN LEADS 0.50 INCH
- 5 WIND COILS EVENLY SPACED AROUND THE CORE CONSTRUCTION:
- 4 THESE SPECIFICATIONS ARE BASED ON LOW RIPPLE CURRENT WEIGHT: ~ 53 GRAM OPERATING TEMP: -55°C TO +180°C HI-POT TEST FOR WINDING TO CORE ISOLATION = 1250 VDC 5 SEC AT IDC OF 10 AMPS, LESS THAN 40 °C TEMP. RISE DCR = 35.0 MILLI-OHMS MAX. INDUCTANCE @ 9 AMP ~ 127 uH (LESS THAN 10% RIPPLE) INDUCTANCE @ 7.5 AMP ~ 140 uH (LESS THAN 10% RIPPLE) INDUCTANCE = 180 uH ± 15% @ LOW DC BIAS, 100 KHZ, 250mV SPECIFICATIONS:

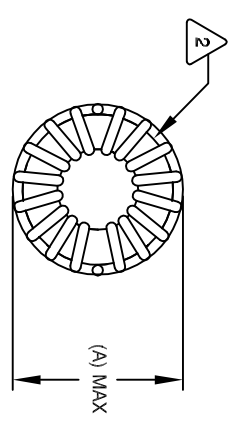

BOTTOM VIEW

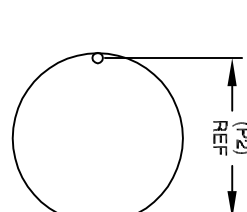

MOUNTING HOLES PATTERN

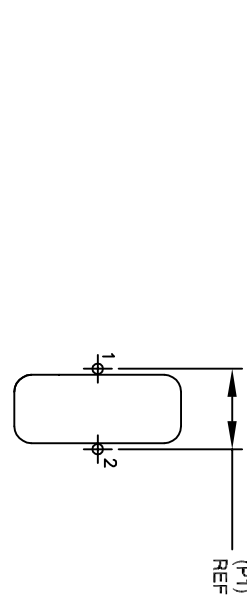

MOUNTING HOLES PATTERN

- 3 WIRE: UL RECOGNIZED 200°C RATED MAGNET WIRE CWS BYTEMARK OR OTHER APPROVED PART CORE: POWDERED TOROIDAL CORE
- 2 RATING CLASS H (180 °C) REQUIRED MATERIAL: UL RECOGNIZED 94V-0 FOR FLAMMABILITY

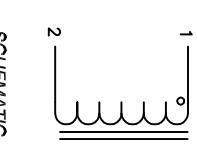

SCHEMATIC

NOTES: UNLESS OTHERWISE STATED, READ NOTES FROM BOTTOM UP

CODE IDENT		MFG. P/N		DESCRIPTION		ITEM NO.
AUTOCAD	X			PARTS LIST		
SOLIDWORKS				CWS Coil Winding Specialist.		
SIGN	DATE			353 W Grove Ave		
				Orange, CA 92865		
TITLE:		POWER INDUCTOR, HIGH TEMP				
DRWN	10/1/10	180 uH, 9 Amp				
CHKD	AK					
ENGR.	10/1/10					
APPR.	10/1/10					
SCALE:		B		SIZE: DIM. IN.		REV
DO NOT SCALE DRAWING		2=1		MF270-181M-9A **		A